

XTOOL | F1 Ultra

Quick Start Guide

Kurzanleitung | Guía de inicio rápido | Guide de démarrage rapide |
Guida rapida | Korte handleiding | Manual de referência rápida |
クイックガイド | 빠른 시작 가이드 | 快速入門指南 | 快速使用指南

XTOOL



01

support.xtool.com/article/1353



Multi-language versions and more information

To find user guides in multiple languages and more help, please visit support.xtool.com/article/1353 or scan the QR code.

Mehrsprachige Versionen und weitere Informationen

Benutzerhandbücher in mehreren Sprachen und weitere Hilfe finden Sie unter support.xtool.com/article/1353 oder scannen Sie den QR-Code.

Versiones en varios idiomas y más información

Para encontrar guías de usuario en varios idiomas y más ayuda, visita support.xtool.com/article/1353 o escanea el código QR.

Versions multilingues et autres informations

Pour trouver des guides d'utilisation en plusieurs langues et plus d'aide, veuillez visiter support.xtool.com/article/1353 ou scannez le code QR.

Versioni multilingue e ulteriori informazioni

Per trovare guide per l'utente in più lingue e ulteriore assistenza, visitate support.xtool.com/article/1353 o scansionate il codice QR.

Meertalige versies en meer informatie

Ga voor gebruikershandleidingen in meerdere talen en meer hulp naar support.xtool.com/article/1353 of scan de QR-code.

Versões em várias línguas e mais informações

Para encontrar guias do utilizador em vários idiomas e mais ajuda, visite support.xtool.com/article/1353 ou leia o código QR.

多言語バージョンと詳細情報

多言語のユーザーガイドとその他のヘルプは、support.xtool.com/article/1353をご覧ください。QRコードをスキャンしてください。

다국어 버전 및 자세한 정보

여러 언어로 된 사용자 가이드와 더 많은 도움말을 찾으려면 support.xtool.com/article/1353 을 방문하거나 QR 코드를 스캔하세요.

多語言版本及更多信息

若要尋找多種語言的使用者指南和更多協助，請造訪 support.xtool.com/article/1353 或掃描二維碼。

多语言版本及更多信息

如需获取其他语言版本的用户指南或更多帮助信息，请访问 support.xtool.com/article/1353 或扫描二维码。你也可以访问 yunque.com/makeblock-help-center-zh/f1-ultra 查看在线帮助。

02

List of items	3
Meet your xTool F1 Ultra	4
Get the machine ready	6
Install accessories	8
Use your xTool F1 Ultra	9
Maintenance	12

List of items



xTool F1 Ultra



Touchscreen controller



Pipe



Power adapter



Power cable



USB cable

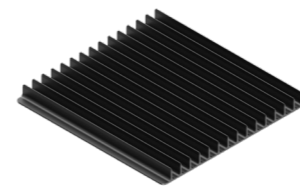

Slatted panel



Screwdriver

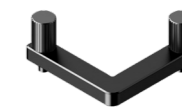

L-shaped positioning piece



Key

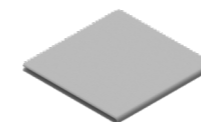

Lint-free cloth



Material pack



Quick Start Guide



Safety Instructions

Meet your xTool F1 Ultra

Product structure

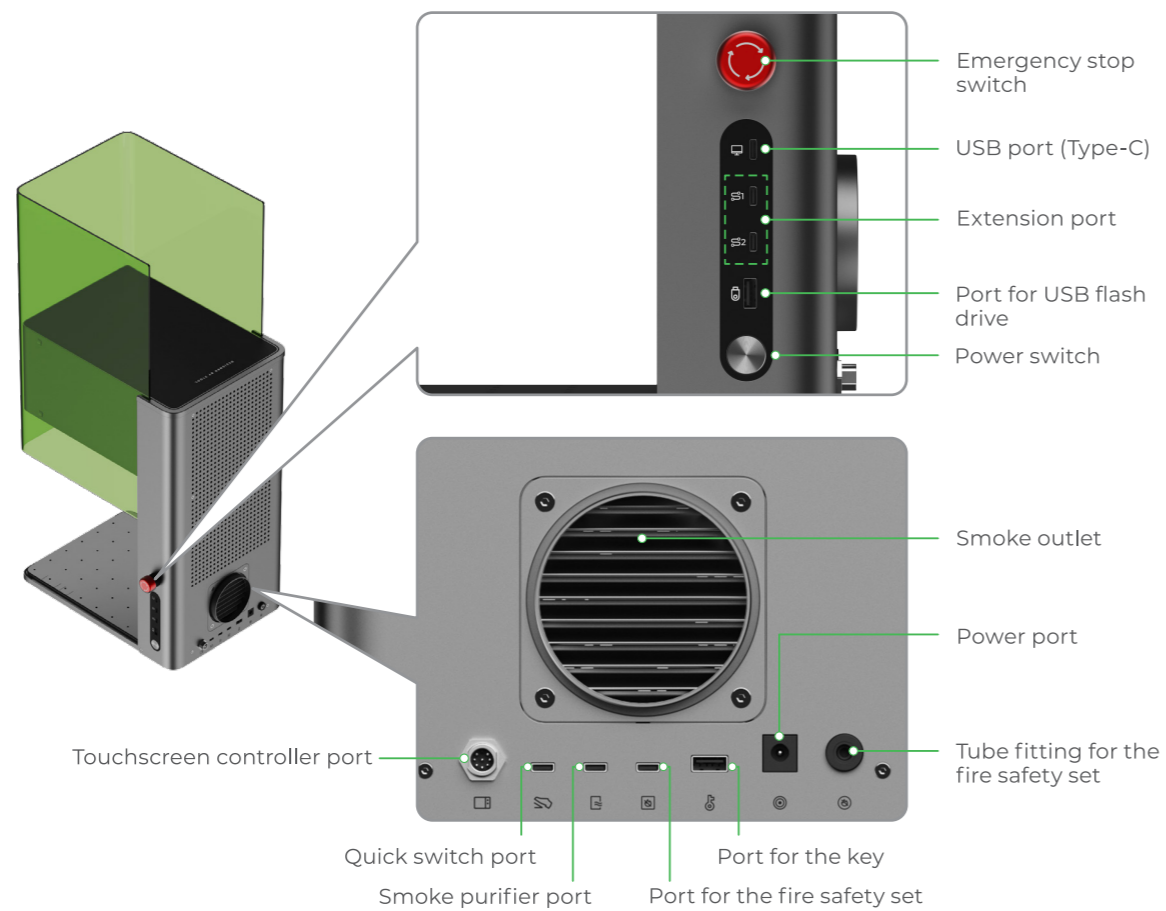
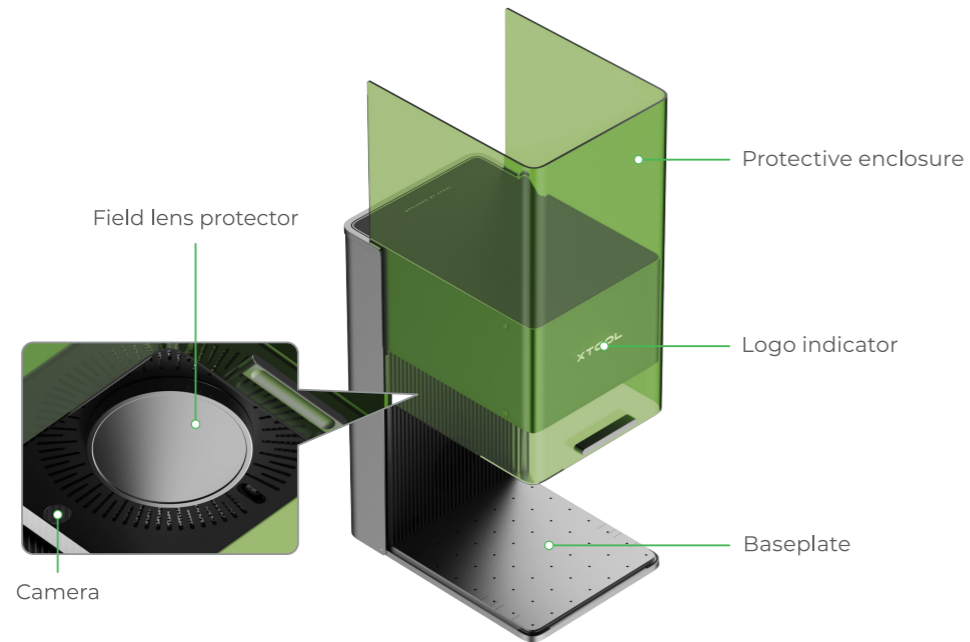

Touchscreen controller

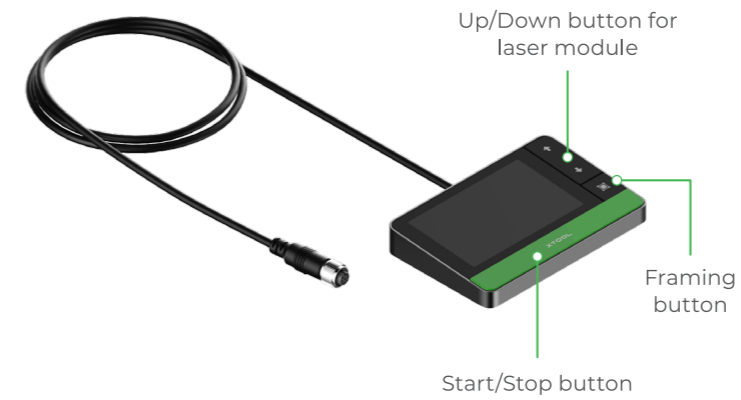

- **Up/Down button for laser module:** Lifts or lowers the laser module during manual focusing.
- **Framing button:** Starts or stops framing.
- **Start/Stop button:** Starts or stops material processing.

Nameplate



XTOOL **F1 Ultra**

Model: MXF-K002-B20 Wavelength: 450±10 nm (20 W)/1064±5 nm (20 W)
 Input power: 24 V = 10 A, 240 W FCC ID: 2AH9Q-MXFK002
 Manufactured by: Makeblock Co., Ltd. IC: 22796-MXFK002
 Company address: Floor 4, Building C3, Nanshan iPark, No. 1001 Xueyuan Avenue, Nanshan District, Shenzhen, Guangdong Province, 518000, China

Complies with 21 CFR 1040.10 and 1040.11 except for conformance with IEC 60825-1 Ed. 3., as described in Laser Notice No. 56, dated May 8, 2019.



Made in China

Specifications

Product name	xTool F1 Ultra
Size	493 mm × 253 mm × 373 mm
Internal working area	220 mm × 220 mm
Maximum processing speed	10,000 mm/s

Input power	24 V = 10 A, 240 W
Laser module	455 nm blue-light laser 1064 nm fiber infrared laser
Laser power	20 W (455 nm) 20 W (1064 nm)
Connection mode	Wi-Fi, USB, IP

Get the machine ready

- 1 Pull down the field lens protector to remove it.

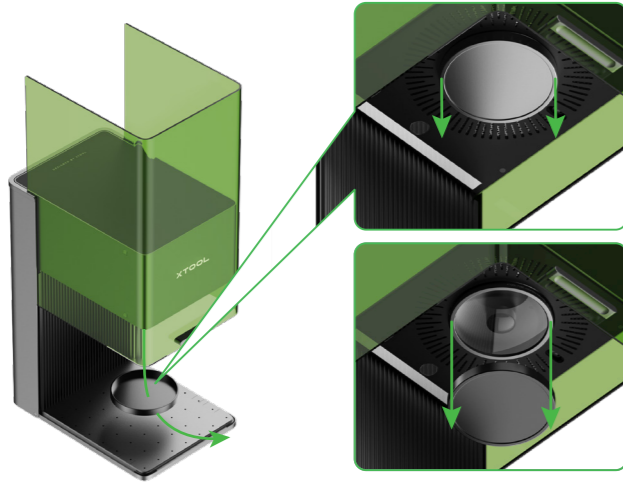

 If you won't use the machine for a long period of time, you can install the protector back to prevent the field lens from getting dusty. Ensure that the protector is removed every time before you use the machine.

- 2 Insert the key.



 **Operation access control**
You can remove the key to disable the processing and related functions of the machine.



- 3 Ensure that the emergency stop switch is released. If it is pressed, rotate to release it.

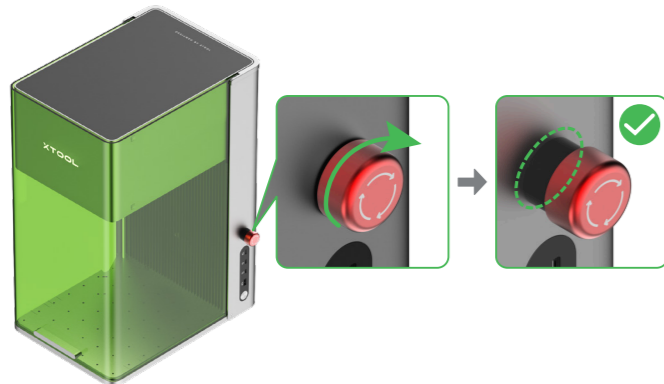

 **Emergency stop**
If an emergency occurs, you can press the emergency stop switch to shut off the machine.

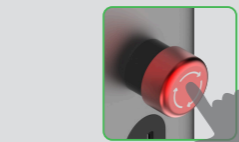

After dealing with the emergency, you can turn the emergency stop switch to reset it.

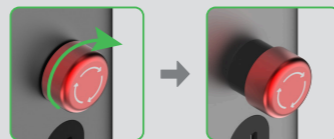

- 4 Install the pipe.

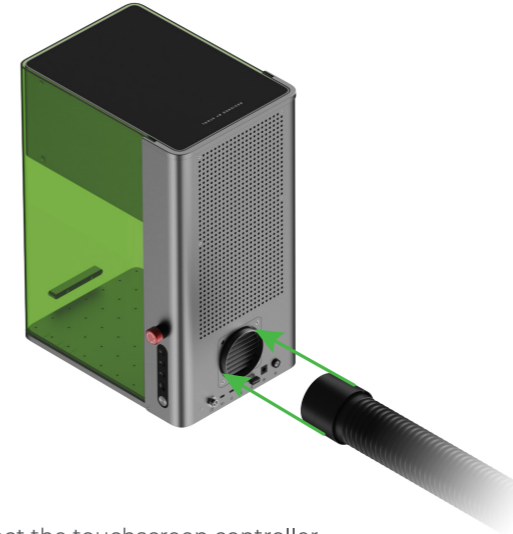

- 5 Connect the touchscreen controller.

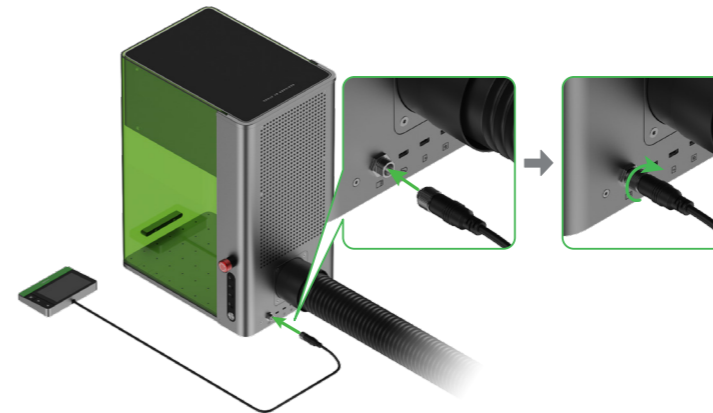

 To insert the connector, ensure that the notch at the end faces up.

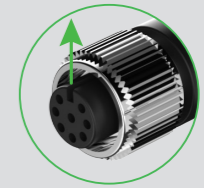

- 6 Connect to a power supply.

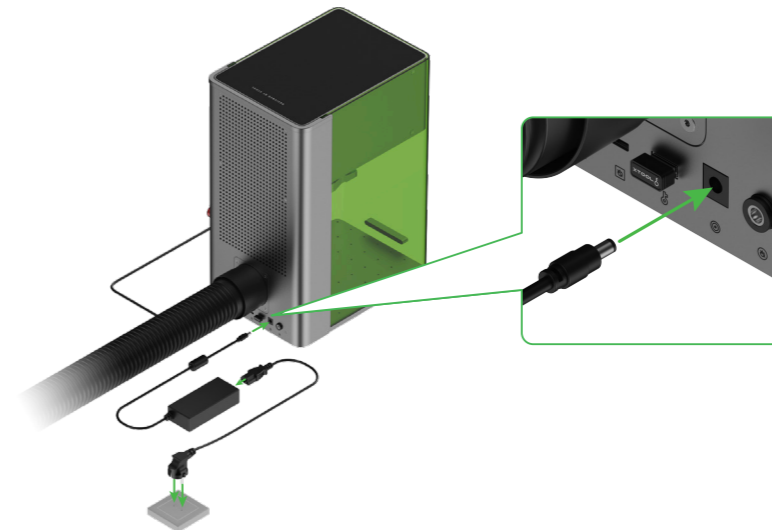

Install accessories

Use the slatted panel

To cut a material, you are advised to use the slatted panel. It can reduce the areas burned during material processing and protect the baseplate.

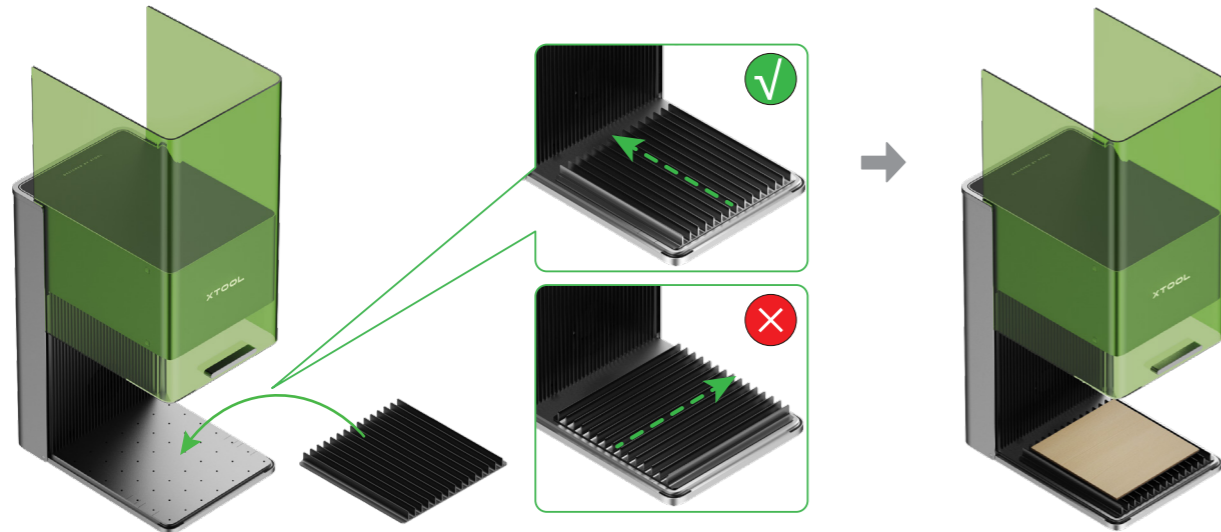

Use the L-shaped positioning piece

During batch processing, the L-shaped positioning piece can help you place a material in the same position every time.

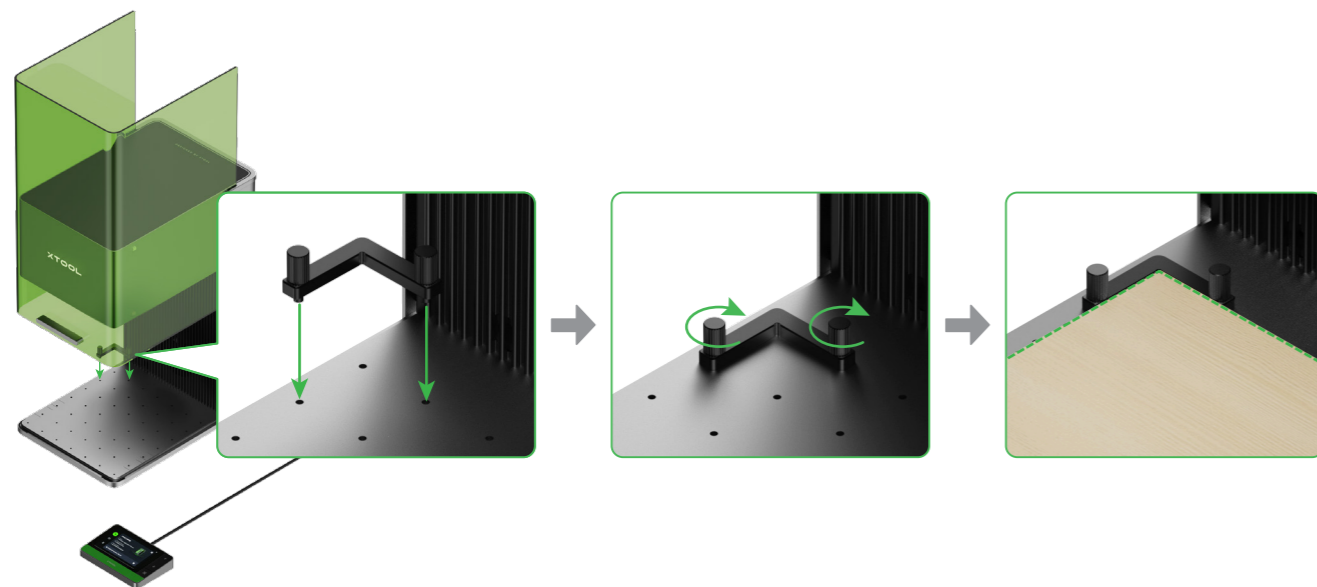

Use your xTool F1 Ultra

Power on and set up language

Press the power switch to turn on xTool F1 Ultra and set the UI language of the touchscreen controller.

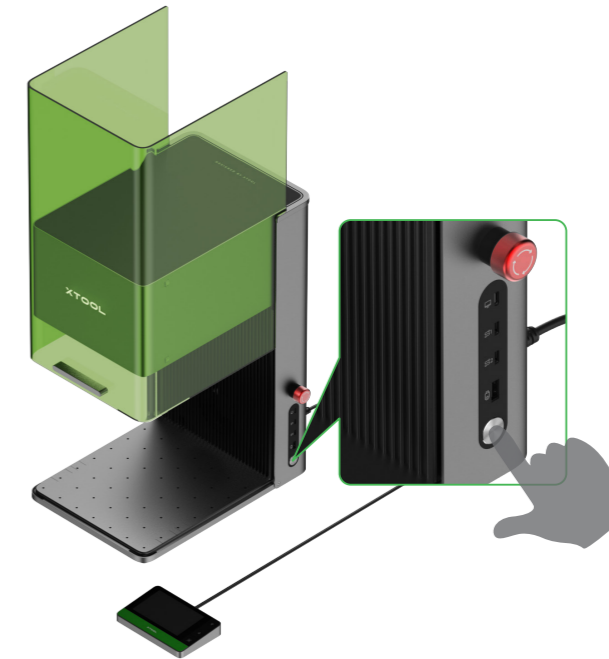

Use software to operate xTool F1 Ultra

For computers

(1) Visit xtool.com/software to download and install xTool Creative Space (XCS).

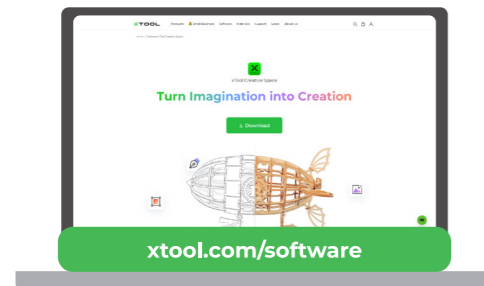

xTool Creative Space

(2) Use the USB cable to connect xTool F1 Ultra to the computer, and then connect xTool F1 Ultra in the software.



For mobile devices

Scan the QR code or search for **xTool Creative Space** in Google Play or App Store, or visit xtool.com/software to download the app and install it.



Follow the online instructions for the App to connect xTool F1 Ultra on the App.

For details about how to use XCS to operate xTool F1 Ultra to process materials, scan the QR code or visit support.xtool.com/product/33.



Maintenance

■ If laser power attenuation occurs, for example, engraved patterns are shallow or materials can't be cut as expected, the field lens may get dirty. Clean it with the lint-free cloth moistened with alcohol.

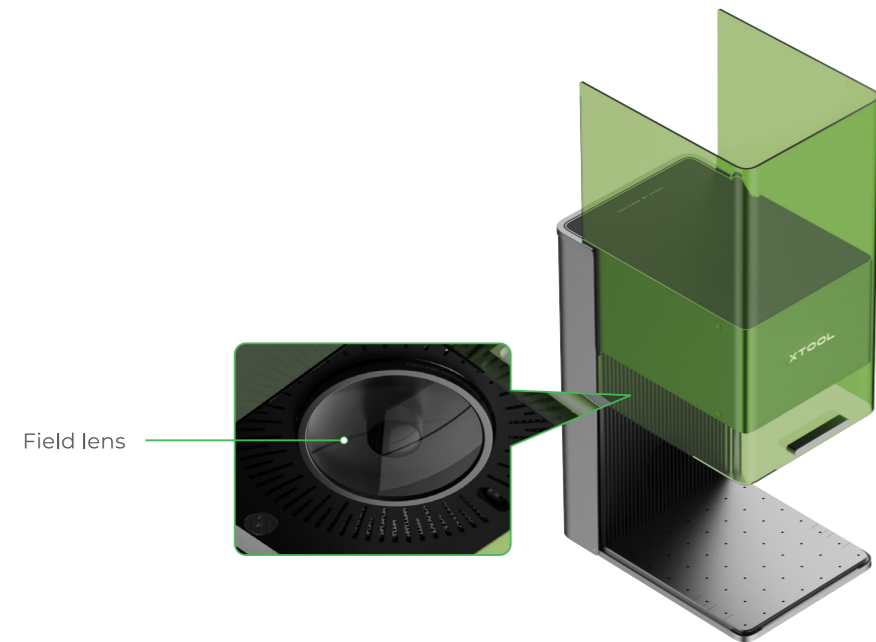

■ If smoke runs out of the protective enclosure, the fan and smoke outlet may be blocked due to dust. Clean them to ensure proper smoke exhausting.

